

## Installation instruction

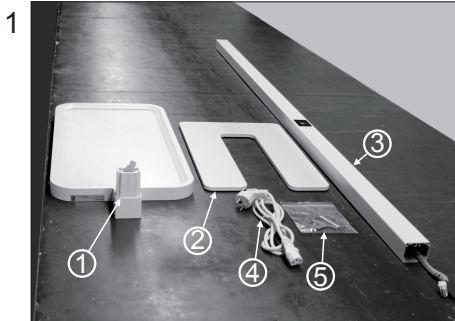

Product list: ① lamp body ② base plate  
③ pole ④ power cord  
⑤ accessories bag

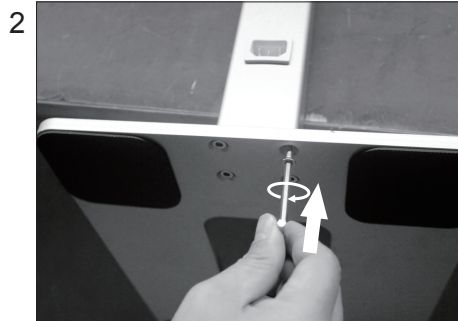

Fix the bottom pole onto base plate

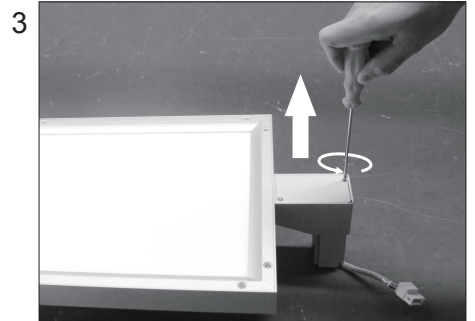

Open the box of lamp body

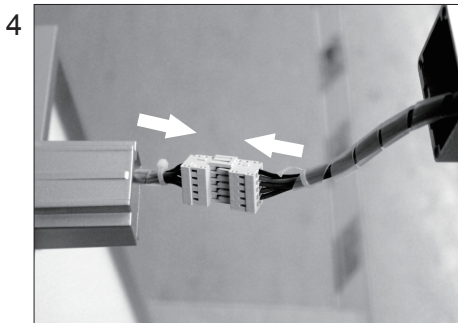

Connect the terminal block

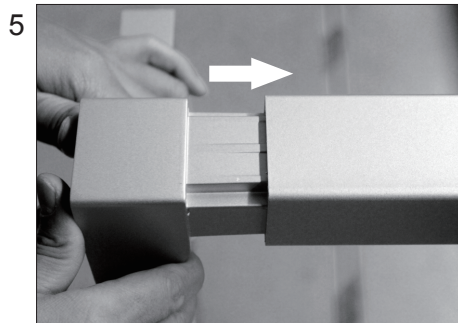

Insert the lamp holder into the other end of the pole

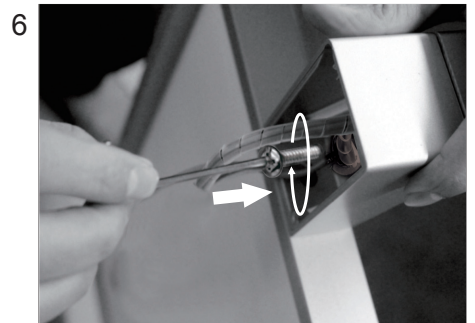

Fix the lamp holder with screws-1

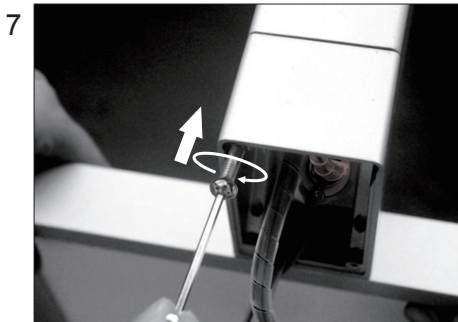

Fix the lamp holder with screws-2



Fix the lamp holder with screws-3

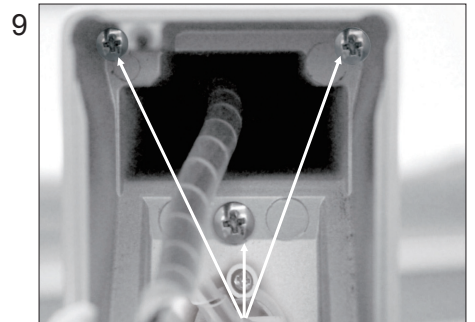

Lamp holder fixed ready by step 6, 7, 8

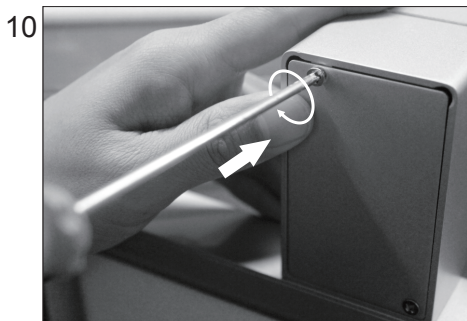

Close the box by screws

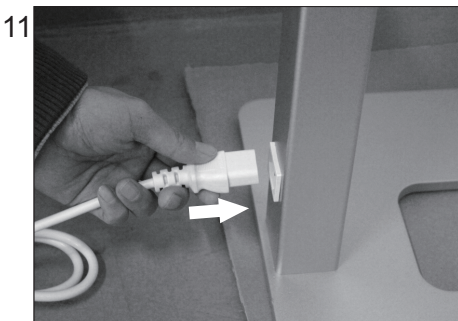

Insert the power cord



12

## Manual



1. Short press to turn on/off.
2. Long press to dimming.

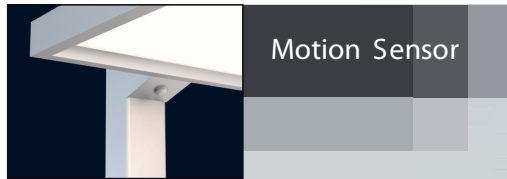

### A. Motion Sensor

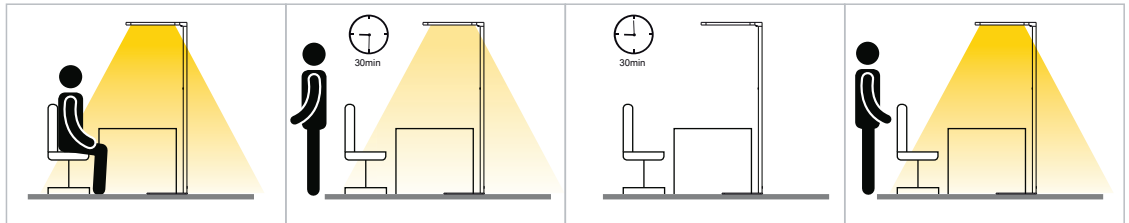

1. turn on the lamp

2. The lamp brightness reduce to 30% when there is no presence in 30min

3. After another 30min, the lamp switches off automatically when still no presence detected

4. The lamp will switch on automatically at once when there is presence detected.